

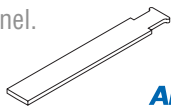

For use with 21/18  
Omega Channel.



**Ancon**

PP21/125	125	250	PP21/200	200	250
PP21/150	150	250	PP21/225	225	250
PP21/175	175	250			

For use with 21/18  
Omega Channel.

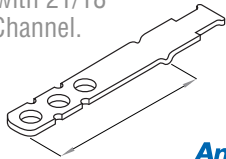

**Ancon**

SD21/125	125	250	SD21/200	200	250
SD21/150	150	250	SD21/225	225	250
SD21/175	175	250			

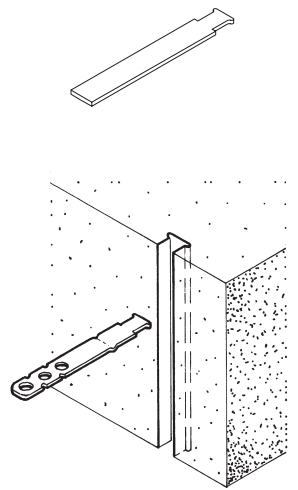

**n**

CST/135	135	250

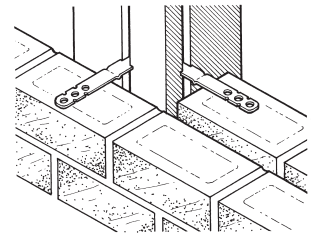

## FRAME TIE



**Ancon**

BUILDSPAN CODE	Length mm	Unit of sale
CSFT/130	130	250



Recommended Lengths for Masonry/Masonry Wall Ties	
Cavity Width mm	Tie Length mm
50-75	200
76-100	225
101-125	250
126-150	275

Recommended Lengths for Frame Cramps and Channel Ties	
Cavity Width mm	Tie Length mm
<20	75
22-44	100
45-69	125
70-94	150
95-119	175
120-144	200
145-169	225