

joint accessories - continued

ANCON 36/8 WALL EXTENSION SYSTEM

The **36/8 WALL EXTENSION SYSTEM** can be supplied with either SP36 ties or, where some longitudinal movement must be accommodated at the joint, PP36 ties. The system is available as a kit comprising a length of 36/8 channel 2400mm long, six ties, five plugs and screws and debonding sleeves.

BUILDSPAN CODE	Description	Unit of sale
WESSP36/8	Kit with SP36 Ties	Per kit
WESPP36/8	Kit with PP36 Ties	Per kit
WEC	36/8 Channel	Per channel

ANCON FASTRACK

Building one leaf of the cavity wall in advance of the other is often beneficial but can create problems with coursing. Buildings which incorporate imperial or continental bricks and standard metric blocks present even greater difficulties.

ANCON FASTRACK CHANNEL is built into the inner leaf of blockwork, ready to take an Ancon SD28 or similar tie for the outer leaf. This method of construction avoids the dangers of projecting ties.

BUILDSPAN CODE	Length mm
FAST/100	100
FAST/150	150

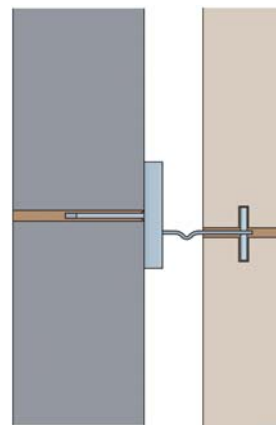

Fastrack used with DD28 Tie for Stonework

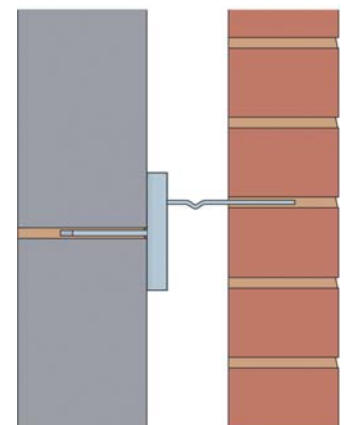

Fastrack used with SD28 Tie for Brickwork

ANCON SMR/TMR MASONRY REINFORCEMENT

ANCON MASONRY REINFORCEMENT offers a low-cost solution to the corrosion problems associated with conventional reinforced masonry. The use of stainless steel minimises the need for close control of mortar cover and ensures continuing structural performance throughout the life of the building or structure.

The lightweight Ancon ladder and lattice type reinforcements are highly ductile and readily cut and shaped on site. This material is totally compatible with our other stainless steel materials and provides many design solutions where structural composite action is required.

Ancon Masonry Reinforcement conforms to BS 5628: Part 2: 2000.

BUILDSPAN CODE	Length mm
SMR60	2.4
SMR100	2.4
SMR150	2.4
SMR225	2.4
SMR225C	2.4
TMR50	3.050
TMR100	3.050
TMR150	3.050

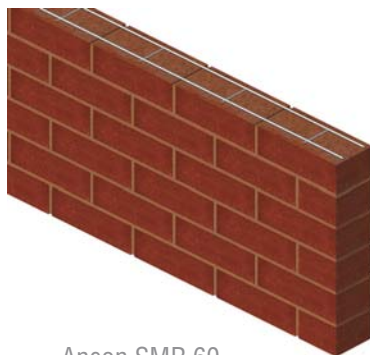

Ancon SMR 60 used on Single Leaf Wall



Ancon TMR 50 used on Single Leaf Wall